

NOTES:

xx	RANGE	y	COLOR
73	250 FSW	A	BLACK
74	300 FSW	B	BLUE
75	350 FSW	R	RED
76	450 FSW	Y	YELLOW
85	1200 FSW	G	GREEN
		W	WHITE

z: 0 - BACK MOUNT
2 - BOTTOM MOUNT

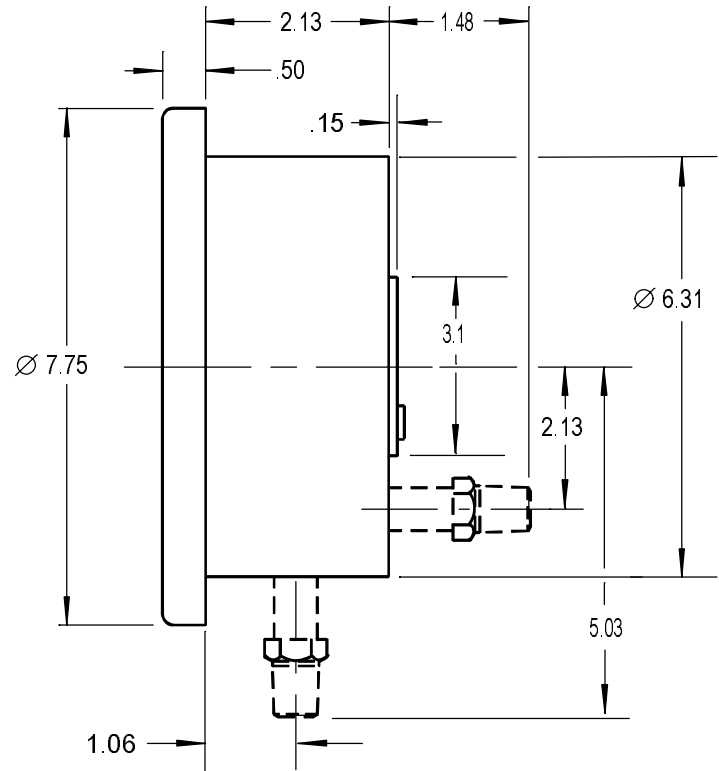
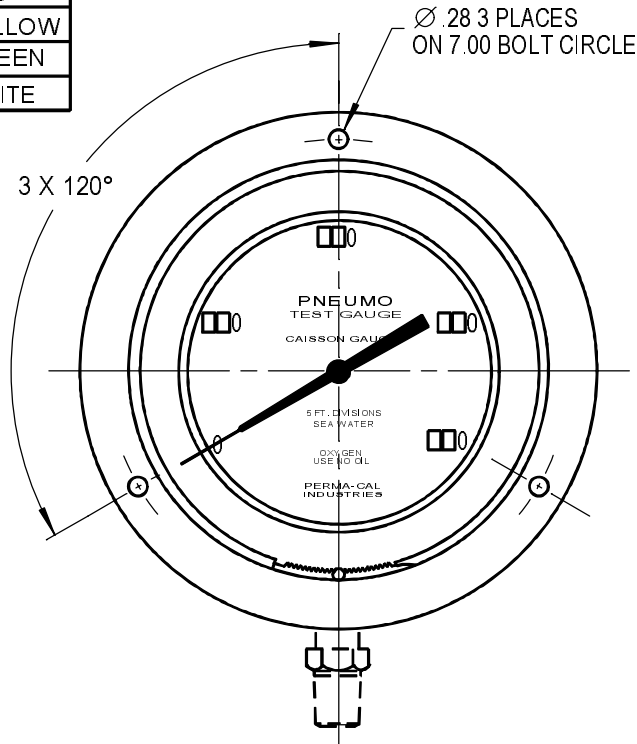

SPECIFICATIONS SUBJECT TO CHANGE WITHOUT NOTICE

UNLESS OTHERWISE SPECIFIED DIMENSIONS ARE IN INCHES		MATERIAL: ABS CASE		CONTRACT NO.		PERMA-CAL INDUSTRIES, INC.							
ANGULAR ± 0° 30'		FINISH:		DATE						CAISSON GAUGE, 6.0" Front Flange, 1/4 NPT			
LINEAR .XX ± .03				PREP BY		PAL 7/20/2010							
FRACTIONAL .XXX ± .015 ± .031				CHECK		REH 11/10/2010							
CORNER AND FILLET RAD. .005-.015 REMOVE ALL BURRS		USED ON:		PROJ ENGR		SIZE		CODE IDENT NO.		DRAWING NO.		REV	
DIAMETERS ON SAME C/L		FILE NAME: 300FTW Top		USED ON:		A		59018		300FTWxyz1-O		N/C	
RUNOUT WITHIN _____ FIR				FILE NAME:		SCALE		NONE		WEIGHT		6.3 lbs.	
✓ SURFACE ROUGHNESS USAS B46.1													

NOTES:

xx	RANGE	y	COLOR
73	250 FSW	A	BLACK
74	300 FSW	B	BLUE
75	350 FSW	R	RED
76	450 FSW	Y	YELLOW
85	1200 FSW	G	GREEN
		W	WHITE

z: 0 - BACK MOUNT
2 - BOTTOM MOUNT

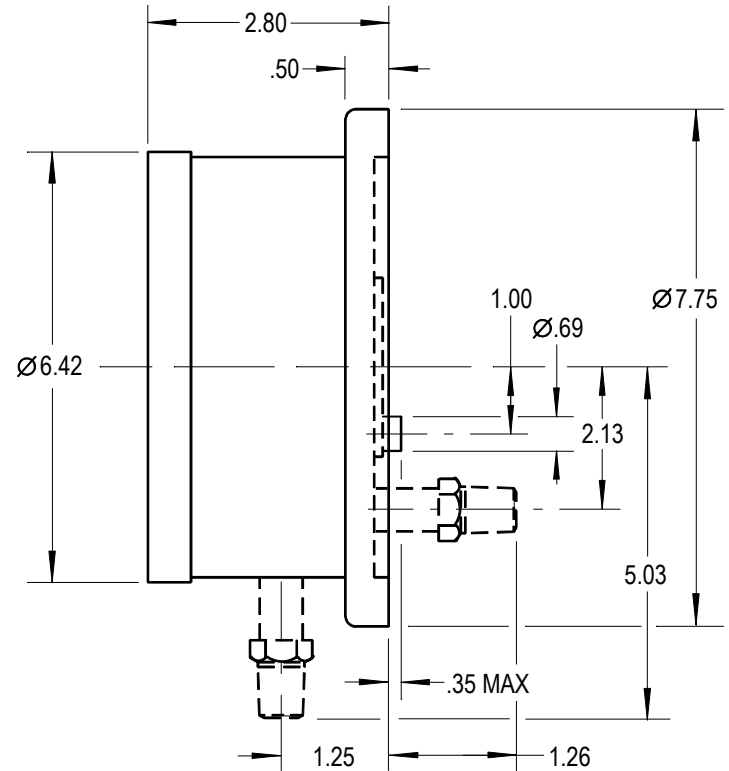
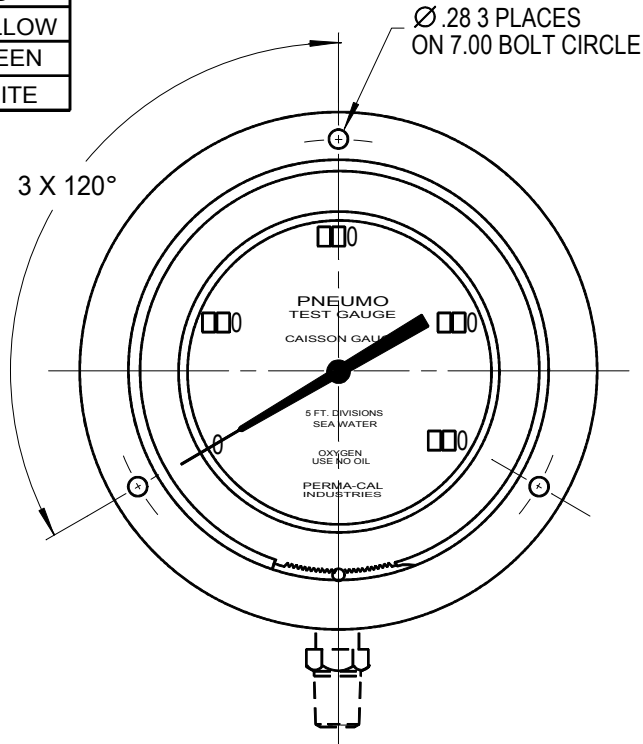

SPECIFICATIONS SUBJECT TO CHANGE WITHOUT NOTICE

UNLESS OTHERWISE SPECIFIED DIMENSIONS ARE IN INCHES		MATERIAL: ABS CASE		CONTRACT NO.		PERMA-CAL INDUSTRIES, INC.					
ANGULAR ± 0° 30'		FINISH:		DATE				CAISSON GAUGE, 6.0" Rear Flange, 1/4 NPT			
LINEAR .XX ± .03				PREP BY		PAL				7/20/2010	
FRACTIONAL .XXX ± .015				CHECK		REH				10/03/2012	
CORNER AND FILLET RAD. .005-.015				PROJ ENGR							
REMOVE ALL BURRS		USED ON:		SIZE		CODE IDENT NO.		DRAWING NO.		REV	
DIAMETERS ON SAME C/L		FILE NAME:		A		59018		300RTWxyz1-O		N/C	
RUNOUT WITHIN _____ FIR		300RTW Top		SCALE		NONE		WEIGHT		6.3 lbs.	
✓ SURFACE ROUGHNESS USAS B46.1				SHEET		1		OF		1	