

NOTES:

REF. BUL. 100 & T-103 FOR THE FOLLOWING:

- b - ACCURACY CODE
 - e - POINTER TYPE
 - f - DIAL TRIM
 - gg - PRESSURE RANGE CODE (T-103)
 - h - CASE COLOR
 - i - FITTING LOCATION
 - j - FITTING TYPE
 - k - OPTIONS*
- * WEIGHT MAY VARY DUE TO THE OPTIONS SELECTED

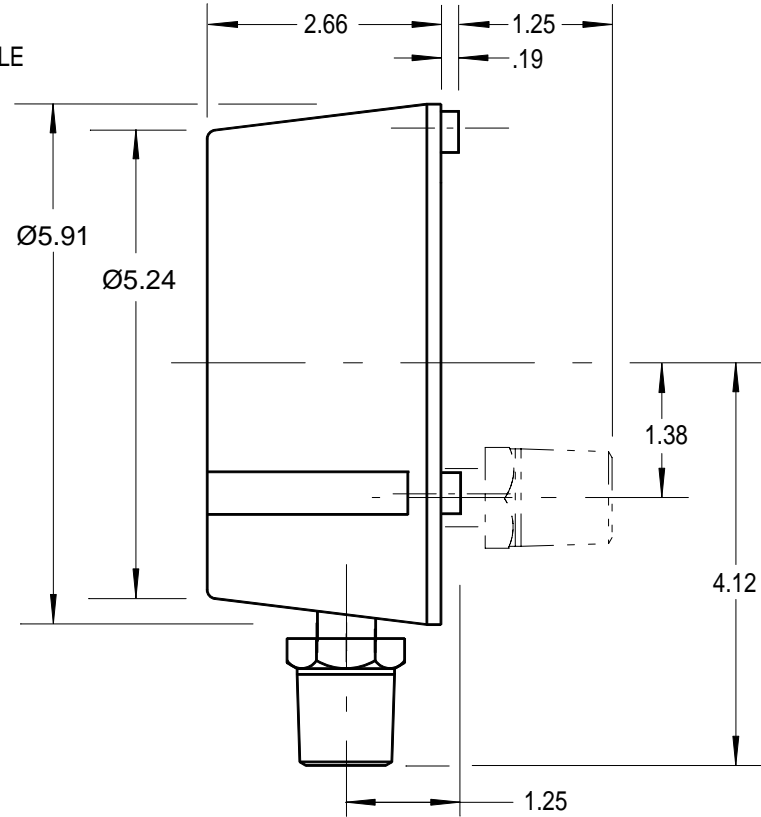
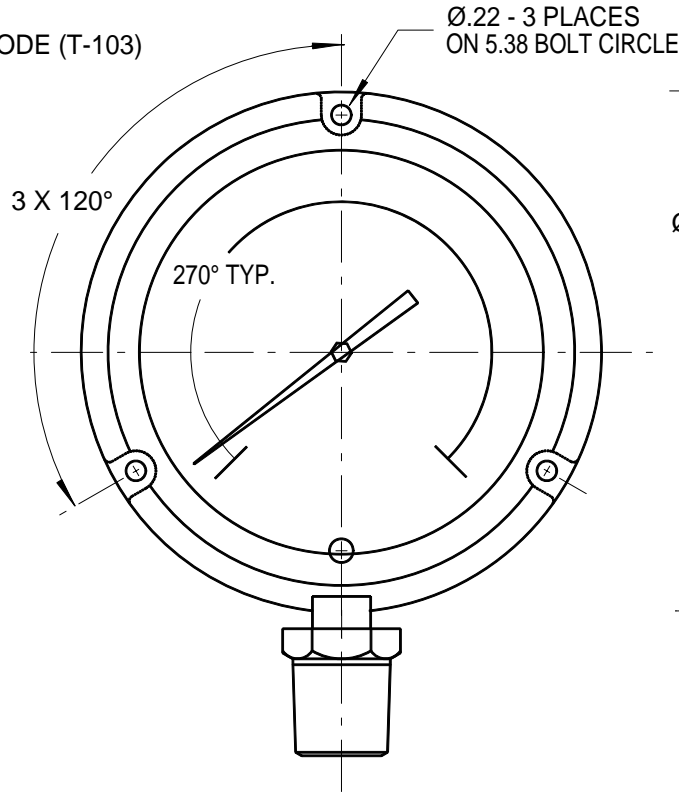

REVISIONS			
REV	DESCRIPTION	DATE	APPROVED

UNLESS OTHERWISE SPECIFIED DIMENSIONS ARE IN INCHES	
ANGULAR	± 0° 30'
LINEAR .XX	± .030
LINEAR .XXX	± .015
FRACTIONAL	± 1/16
CORNER AND FILLET RAD. .005-.015 REMOVE ALL BURRS	
DIAMETERS ON SAME C/L RUNOUT WITHIN _____ FIR	
SURFACE ROUGHNESS USAS B46.1	

MATERIAL:	CONTRACT NO.
CASE - ABS OR GFN FITTING - 316 CRES COIL - INCONEL X-750	DATE
	PREP BY: REH 5/22/2007
FINISH:	CHECK: Tuttle 11/2018
	PROJ ENGR
USED ON:	INDUSTRIAL GAUGES
	FILE NAME: 1b1Tefgghij

PERMA-CAL INDUSTRIES, INC.			
TURRET GAUGE, 4 1/2"			
SIZE	CODE IDENT NO.	DRAWING NO.	REV
A	59018	1b1Tefgghij-k	N/C
SCALE	WEIGHT	SHEET	OF
NONE	1.18 lbs nom*	1	1

